



# AIRSTREAM SKYDECK → 390



## THE SKY'S THE LIMIT

### → FEATURES

- *The industry's only rooftop deck - complete with cushioned seating, automatic raising safety rails, a king-sized sun lounger and barbeque area.*
- *Full galley/lounge slide-out in the main coach.*
- *Panoramic windows for spectacular views.*
- *20" TV, satellite and DVD prewire, cable and telephone hook-up comes standard.*
- *Available custom paint (Red Metallic shown).*

Go ahead, expand your entertainment options and give your guests a unique 'view from the top' - get an AIRSTREAM SKYDECK.

Are you looking for new ways to enjoy the RV lifestyle and to distinguish your coach from your neighbors? Then the Airstream SkyDeck is your hottest ticket in town. The deck, which is accessible via residential stairs from inside the motorhome, lets you enjoy outdoor entertaining and activities from the comfort of your motorhome. The SkyDeck patio, while adding an entire new living level, only adds ten inches of height to a standard coach, allowing the Airstream motorhome to retain a low profile.



**AIRSTREAM**  
SEE MORE DO MORE LIVE MORE



419 West Pike Street, P.O. Box 629, Jackson Center, OH 45334  
Telephone: 937-596-6111 [www.airstream.com](http://www.airstream.com)



# FLOORPLANS

# SKYDECK 390

2004

## SKYDECK 390 upper level

standard roof patio contents: hatchway with safety rail, 3 sofas, sunlounger, BBQ area with wet bar, floor lighting, perimeter safety rail, power lift safety rail, 4 end tables, 3 umbrella holders

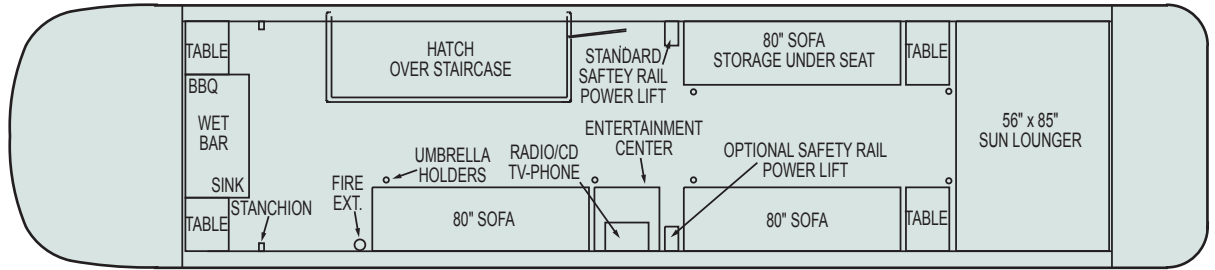

## SKYDECK 390 lower level

with slide-out living room and galley  
slide-out dimensions: interior size 17"D x 160"L x 64 1/2"H  
electric operation

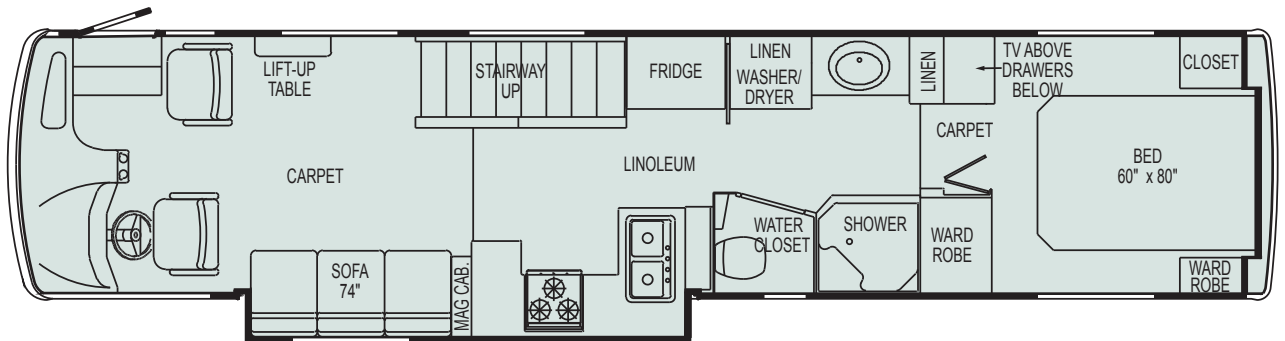

# SPECIFICATION SKYDECK XL

2004

SKYDECK XL	390XL	DRIVER COMPARTMENT	390XL
Exterior height w/skydeck	12' 6"	Driver & co-pilot seats w/swivel and recline	STD
Interior head room	78 1/2"	Ultra Leather powered driver seat w/Vibrasonic	OPT
Interior width	95"	Ultra Leather powered co-pilot seat w/power foot rest & Vibrasonic	OPT
Exterior length	39'	Integrated 3-point seat belts w/retractors (ISS)	STD
Exterior width	101"	Driver/co-pilot map lights w/separate switches	STD
Exterior storage volume (cu. ft.)	154	CB prewire w/antenna	STD
Freightliner XC 330 HP Caterpillar w/252" wheel base	STD	Privacy blackout curtain (wrap around) pleated	STD
UBW (Unit Base Weight) w/full fuel tank	26,357	A/C w/side window defroster & electronic rotary control	STD
NCC (Net Carrying Capacity)	4,643	Auxiliary defroster fans - chrome	STD
GVWR (Gross Vehicle Weight Rating)	31,000	Front overhead cabinet w/VCC-(prepped for satellite receiver)	STD
Adjustable pedals, ABS brakes, air suspension & raised rail chassis	STD	Instrument panel (analogue) & 12V power ports (2) w/1 lighter & headlight buzzer	STD
Rear axle ratio	4.63:1	Tilt / telescopic steering column w/18" wheel	STD
Tire size: 275/70r 22.5 XZA1 Rim size: 22.5 X 8.25	STD		
P.S.I. @ maximum tire load	95	<b>INTERIOR</b>	<b>390XL</b>
GAWR front	12,000	Cabinets: natural oak vinyl w/hardwood face frames	STD
GAWR rear	19,000	Brass/chrome acrylic hardware, laminate tables and countertops	STD
Seating capacity	5	Vinyl floor - galley/bath area	STD
Sleeping capacity	4	Lounge w/removable arm rests (converts to bed) w/directional reading lights (Ultra Leather optional)	STD
In block heater - on board outlet provided	STD	Bedroom mattress - innerspring (pillow top style)	STD
50 state emissions	STD	Pure Touch Classic faucet w/spray	STD
Fuel tank (150 gallons)	STD	Porcelain sink w/7" deep double bowl & 2 sink covers	STD
Michelin radial tires & 4 aluminum wheels	STD	One piece fiberglass garden shower w/shower light	STD
Alternator w/heavy duty isolator	160 AMP	Bi-fold bath/bedroom door	STD
Electric operated entrance step (double)	STD	Washer/dryer cabinet w/laminate top	STD
Trailer hitch 1,000 HW/10,000 GVW	STD	<b>APPLIANCES</b>	<b>390XL</b>
Intellitac battery control system	STD	3-burner range top w/storage drawers	OPT
Battery, main - Delco Maintenance Free	2	3-burner range w/oven & bi-fold range cover & convection microwave	STD
Battery, auxiliary (2EA 4D) w/roll out tray	STD	Dometic 10 cu. ft. refrigerator & U-Line ice maker	STD
Emergency start solenoid (momentary)	STD	Dometic 12 cu. ft. refrigerator w/ice maker (NDR1292IMH)	OPT
Leveling jacks (semi automatic control - power gear)	STD	10 gallon gas/elec. DSI water heater	STD
Control stick: turn signal, cruise control, wipers/washer, hi-low beams	STD	Dual furnace (34,000 BTU w/above floor duct system) & 16,000 BTU	STD
Battery disconnect (12V at entrance door w/on-off indicator light - coach batteries)	STD	Air conditioners w/low profile heat pump (2) 13,500 BTU w/ceiling duct, quick cool return air grille & comfort control center	STD
Pantograph wipers w/wet arm, back-up warning buzzer	STD	20" stereo TV w/interlock (front overhead roof locker)	STD
Transmission temperature gauge & exhaust brake	STD	20" stereo TV in bedroom w/swing out cabinet	STD
		VCR - hi-fi stereo	OPT
<b>LPG - WATER - WASTE</b>	<b>390XL</b>	Video control center (VCC) & TV antenna - Omni directional w/power booster	STD
LPG tank (lbs)	182	Cable hook-up (coach & roof), telephone hook-up (2) bedroom & CS cab	STD
Fresh water tank w/drain (gal)	105	Smoke, carbon monoxide & LPG detectors	STD
Gray water holding tank (gal)	79	Washer/dryer combination - vented	OPT
Black water holding tank (w/No-Fuss flush system) (gal)	55	Satellite dish/receiver pre-wire	STD
Heated holding tanks & fire extinguisher	STD	<b>ELECTRICAL</b>	<b>390XL</b>
Floor safe	OPT	12V fluorescent recessed ceiling lighting w/R.F.I. ballast	STD
Dual fuel fill w/hinged door (RS/CS)	STD	Probeless tank monitoring system	STD
Water heater by-pass	STD	Roof vent w/fan, power vent in water closet w/power lift	STD
City water hook up w/water fill diverter valve	STD	Fantastic roof vent w/built-in thermostat & rain sensor (lounge/galley area)	STD
Utility compartment w/S.S. face - chrome hot & cold long neck faucet	STD	Rearview TV monitor audio/video w/two position camera & fiberglass cover	STD
Gravity fresh water fill & manual dump valve	STD	Electric keyed dead bolt - main door	STD
<b>EXTERIOR</b>	<b>390XL</b>	Keyless entry (features a 4-channel remote)	STD
Custom painted exterior/clear coat with paint protective film - Red Metallic, Blue Ice, Silver Frost, Racing Green	STD	Exterior lighting package: patio/utility/step lights & baggage compartment lights	STD
Awning (patio) manual - (power awning optional)	STD	120 VAC exterior outlet (CS/RS) inside compartments (1 each - roof)	STD
Awning (front door or window package)	OPT	Exterior C.S. TV jack/12V outlet (1 each - roof)	STD
Heated exterior mirrors w/remote control - painted (chrome optional)	STD	50 amp service (includes 50 amp power cord 36' male end only)	STD
Basement storage w/insulated aluminum single point latch doors	STD	2000 watt inverter/charger	STD
Dual pane windows w/tinted glass (30% light transmitted)	STD	6 radio speakers (includes bedroom)	STD
Front entry door w/inside powered step cover	STD	TV sound through front 4 speakers	STD
<b>Standard roof patio contents:</b> Hatchway with safety rail, 3 sofas, sunlounger, BBQ area with wet bar, floor lighting, perimeter safety rail, power lift safety rail, 4 end tables, 3 umbrella holders		Dash JVC radio AM/FM/cassette, digital w/CD controller & 4 speakers	STD
<b>Roof patio options:</b> 2 umbrellas, area lighting, 3 additional umbrella holders		DVD surround sound system w/5 speakers & 1 sub woofer	STD
Entertainment center: AM/FM/CD, 110V, 12V, TV, phone hook-ups, & 4 exterior 5" weatherproof speakers		2 slide-out galley/lounge wall sconce lights	STD
		12 unit CD changer w/remote	OPT
		Slide-out 8.0kw quiet diesel generator w/bedroom start switch	STD
		Power reel for shore cord	OPT

**All these features and more in your new Land Yacht!** Specifications are subject to change without notice. Canadian specifications will differ from U.S.

**AIRSTREAM™**  
SEE MORE DO MORE LIVE MORE



419 West Pike Street, P.O. Box 629, Jackson Center, OH45334  
Telephone: 937-596-6111 [www.airstream.com](http://www.airstream.com)